



The Rother

2 bedroom home

Step inside the Rother and you'll find an inviting lounge leading through to an open plan dining kitchen with door leading out onto the garden, it's a light, bright, comfortable space, whether you're cooking for the family or hosting friends.

A useful cloakroom finishes off the ground floor.

To the first floor are two good sized bedrooms, both with built-in wardrobes and an attractive modern bathroom.

Outside is a turfed garden and off road parking.



Features

- *Inviting lounge*
- *Open plan dining kitchen with door to garden*
- *Downstairs cloakroom*
- *Two good sized bedrooms with built-in wardrobes*
- *High quality kitchen appliances*
- *Hive smart heating system*
- *Fully turfed rear garden*

Room Dimensions

Ground Floor

Lounge	15'8" x 9'7" (max)	4.79m x 2.93m (max)
Kitchen/Dining	12'11" x 10'11"	3.96m x 3.35m
Cloakroom	5'10" x 2'9"	1.79m x 0.86m

First Floor

Bedroom 1	12'11" x 10'2"	3.96m x 3.10m
Bedroom 2	10'8" x 9'4"	3.26m x 2.85m
Bathroom	7'6" x 5'9"	2.30m x 1.77m

Ground Floor

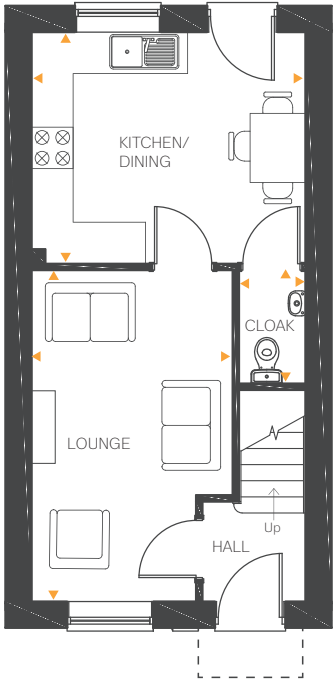

First Floor

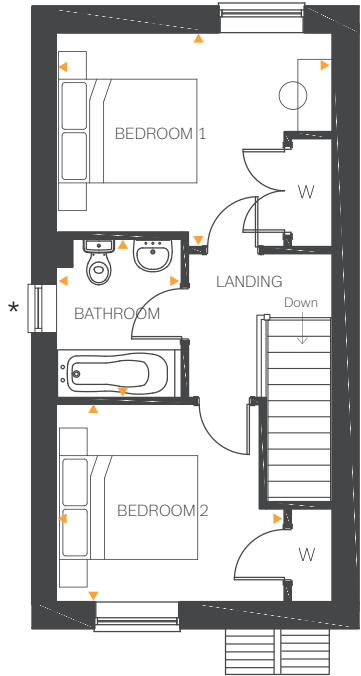

*Window included on selected plots.