

THE MINSMERE

TWO BEDROOM HOME



From the Minsmere's pretty gabled doorway you'll find an inviting lounge and contemporary dining kitchen with attractive views of the rear garden, where you can step outside for some fresh air or fire up the BBQ in summer. A cloakroom finishes off the ground floor.

Upstairs, you'll find two generous bedrooms, each with built-in wardrobes, plus a thoughtfully designed modern family bathroom.

Outside is a turfed garden and off road parking.

THE MINSMERE

TWO BEDROOM HOME



Inviting lounge



Open plan dining kitchen



Downstairs cloakroom



Two good sized bedrooms with built-in wardrobes



High quality kitchen appliances



Hive smart heating system



Fully turfed rear garden



Off road parking

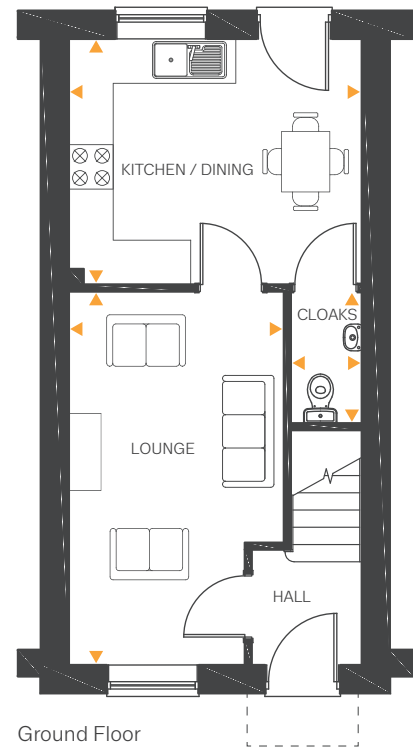

Ground Floor

| | | |
|----------------|-----------------|---------------|
| Lounge | 16'6" x 9'6" | 5.04m x 2.90m |
| Kitchen/Dining | 12'11" x 10'10" | 3.96m x 3.32m |
| Cloakroom | 5'10" x 2'9" | 1.78m x 0.86m |

First Floor

| | | |
|-----------|---------------|---------------|
| Bedroom 1 | 10'2" x 10'0" | 3.96m x 3.07m |
| Bedroom 2 | 10'8" x 9'11" | 3.26m x 3.04m |
| Bathroom | 7'0" x 5'9" | 2.15m x 1.77m |

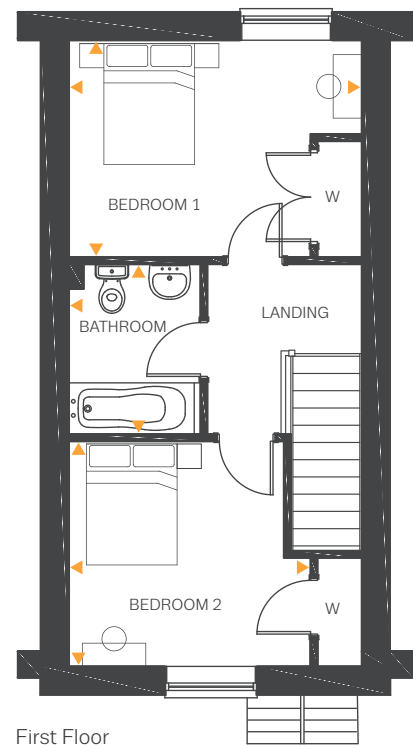

All drawings, plans, and images are for illustrative purposes only. Room measurements are approximate. Finishes and layouts may vary and, during the construction process, plans might be subject to change. For more information, speak to your Sales Consultant.