

THE ROTHER

TWO BEDROOM HOME



Step inside the Rother and you'll find an inviting lounge leading through to an open plan dining kitchen with door leading out onto the garden, it's a light, bright, comfortable space, whether you're cooking for the family or hosting friends. A cloakroom finishes off the ground floor.

To the first floor are two good sized bedrooms, both with built-in wardrobes and an attractive modern bathroom.

Outside is a turfed garden, off road parking and EV charger.

THE ROTHER

TWO BEDROOM HOME



Inviting lounge



Open plan dining kitchen with door to garden



Downstairs cloakroom



Two good sized bedrooms with built-in wardrobes



High quality kitchen appliances



Hive smart heating system



Fully turfed rear garden



Off road parking



EV Charger

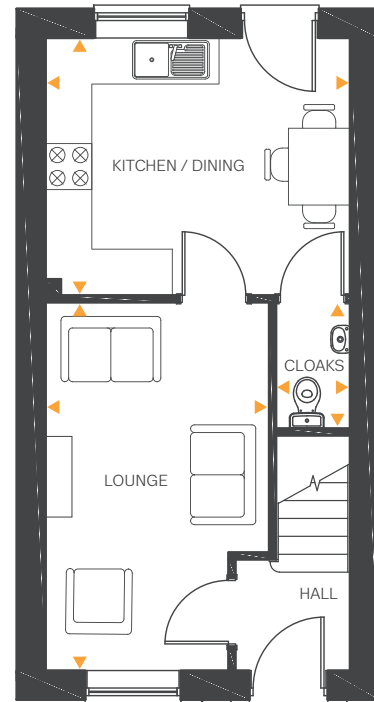

Ground Floor

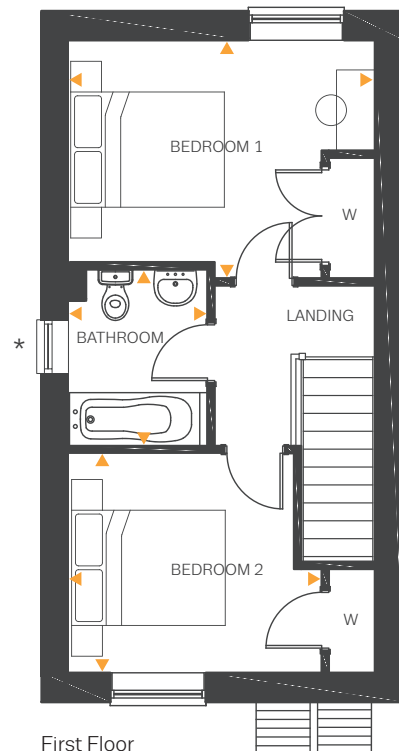

First Floor

*Window included on selected plots.

Ground Floor

Lounge	15'8" x 9'7" (max)	4.79m x 2.93m (max)
Kitchen/Dining	12'11" x 10'11"	3.96m x 3.35m
Cloakroom	5'10" x 2'9"	1.79m x 0.86m

First Floor

Bedroom 1	12'11" x 10'2"	3.96m x 3.10m
Bedroom 2	10'8" x 9'4"	3.26m x 2.85m
Bathroom	7'6" x 5'9"	2.30m x 1.77m