

THE HARTBURY

THREE BEDROOM HOME



Computer generated images are for illustration purposes only.

Designed for the modern family, the Hartbury is a welcoming home which includes an inviting lounge, an open plan dining kitchen with French doors that create a lovely bright space and a convenient cloakroom.

To the first floor there's a large principal bedroom with built-in wardrobe, two further bedrooms, one with built-in storage, and a modern family bathroom.

Outside there is a fully turfed garden and driveway.

THE HARTBURY

THREE BEDROOM HOME



Inviting lounge



Open plan dining kitchen with French doors to garden



Principal bedroom with built-in wardrobe



High quality kitchen appliances



Hive smart heating system



Fully turfed rear garden



Off road parking

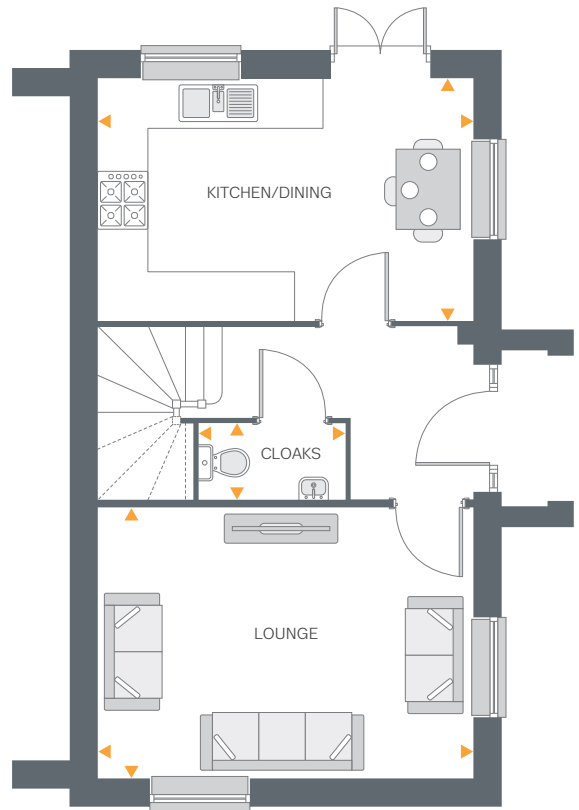

Ground Floor

Ground Floor

Lounge	15'2" x 10'11"	4.63m x 3.33m
Kitchen/Dining	15'2" x 9'9"	4.63m x 2.99m
Cloakroom	5'10" x 2'11"	1.80m x 0.91m

First Floor

Bedroom 1	15'2" x 11'1"	4.63m x 3.38m
Bedroom 2	10'11" x 6'11"	3.33m x 2.12m
Bedroom 3	7'11" x 7'8"	2.42m x 2.35m
Bathroom	7'4" x 6'3"	2.24m x 1.91m

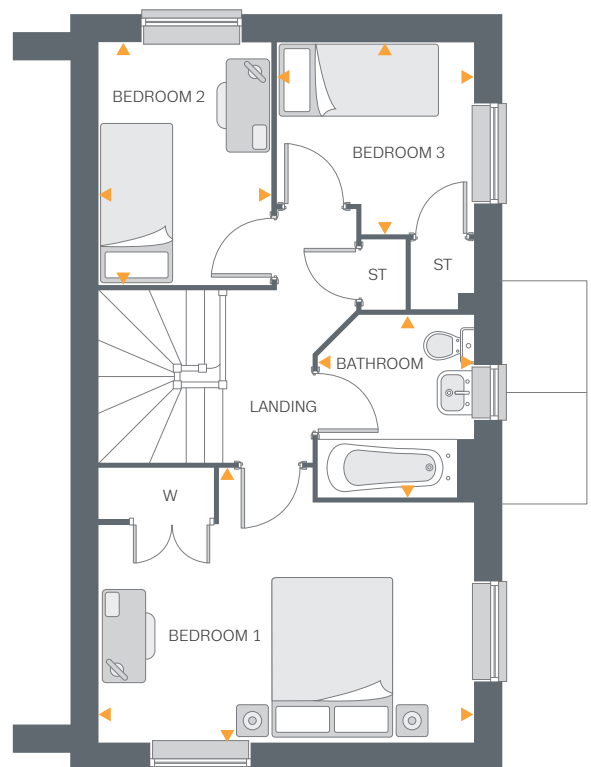

First Floor

All drawings, plans, and images are for illustrative purposes only. Room measurements are approximate. Finishes and layouts may vary and, during the construction process, plans might be subject to change. For more information, speak to your Sales Consultant.