

THE HAYLE

TWO BEDROOM HOME



The Hayle is a thoughtfully designed two bedroom home, perfect for modern living. Step into a welcoming hallway that opens into a bright and comfortable lounge, ideal for relaxing evenings or entertaining friends. To the rear, the open plan kitchen and dining area is both stylish and practical, with a door leading out to the garden. A downstairs cloakroom completes the ground floor.

Upstairs, you'll find two generous bedrooms and a well appointed family bathroom. The second bedroom is a flexible space, ideal for use as a nursery, guest room, or a peaceful home office.

Outside, there's an enclosed fully turfed rear garden and convenient off road parking, making life that little bit easier.

THE HAYLE

TWO BEDROOM HOME



Inviting lounge



Open plan kitchen & dining area



Downstairs cloakroom



Two good sized bedrooms



Contemporary fitted bathroom



Fully turfed enclosed rear garden



Off road parking

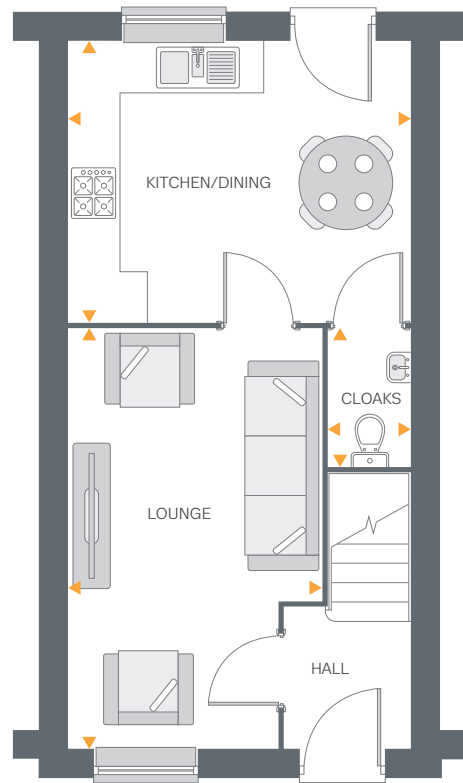

Ground Floor

Ground Floor

Kitchen/Dining	13'4" x 11'0"	4.07m x 3.35m
Lounge	16'5" x 9'11"	5.01m x 3.02m
Cloakroom	5'5" x 3'2"	1.64m x 0.96m

First Floor

Bedroom 1	13'4" x 10'1"	4.07m x 3.08m
Bedroom 2	13'4" x 10'2"	4.07m x 3.10m
Bathroom	6'10" x 5'10"	2.09m x 1.78m

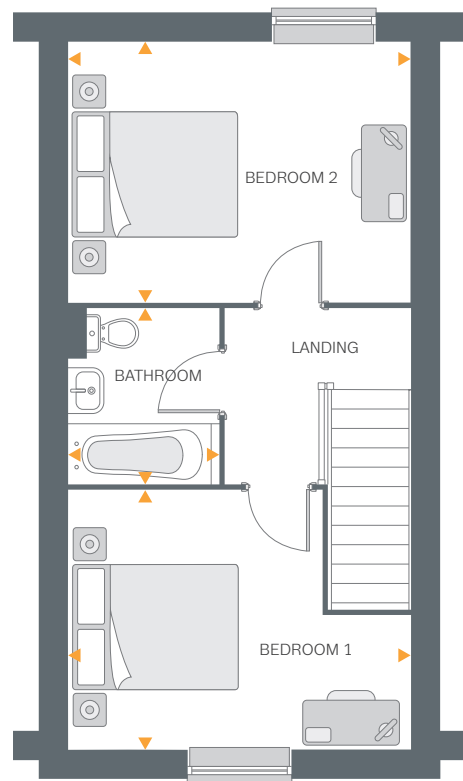

First Floor