

THE LEA

THREE BEDROOM HOME



Thoughtfully laid out and full of great design details, the Lea is an attractive and practical home. The spacious lounge has a beautiful bay window and leads through to an open plan dining kitchen with separate utility room and cloakroom. The French doors from the dining area take you straight out to the garden, creating a light, airy space you'll love all year round.

To the first floor, you'll find a principal bedroom with built-in wardrobe and en-suite, plus two further bedrooms and a modern family bathroom. Looking for space to work from home? Bedrooms two or three would make the perfect home office.

Outside there is a turfed garden, driveway, and garage.

THE LEA

THREE BEDROOM HOME



Inviting lounge



Open plan dining kitchen with French doors to garden



Downstairs cloakroom



Principal bedroom with built-in wardrobe & en-suite



High quality kitchen appliances



Hive smart heating system



Fully turfed rear garden



Driveway & garage

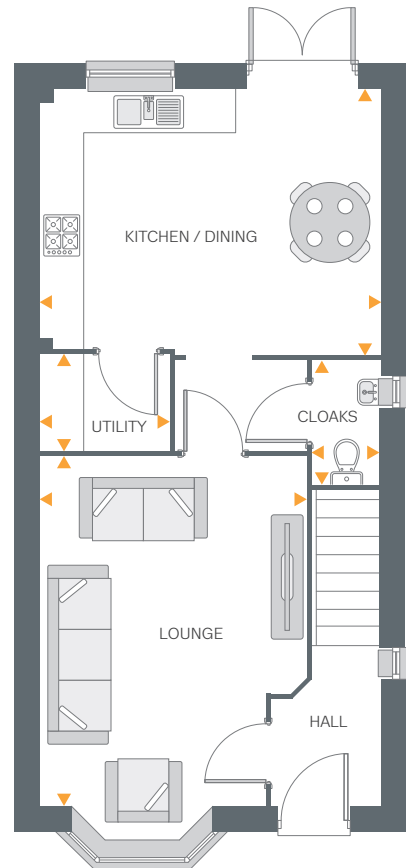

Ground Floor

Ground Floor

Lounge	16'0" x 12'3"	4.89m x 3.74m
Kitchen/Dining	15'6" x 12'1"	4.74m x 3.70m
Utility	5'9" x 4'3"	1.77m x 1.32m
Cloakroom	5'8" x 2'11"	1.73m x 0.91m

First Floor

Bedroom 1	13'5" x 12'1"	4.10m x 3.70m
En-suite	5'11" x 5'5"	1.82m x 1.67m
Bedroom 2	13'7" x 8'6"	4.16m x 2.61m
Bedroom 3	10'3" x 6'8"	3.12m x 2.04m
Bathroom	8'6" x 7'6"	2.61m x 2.30m

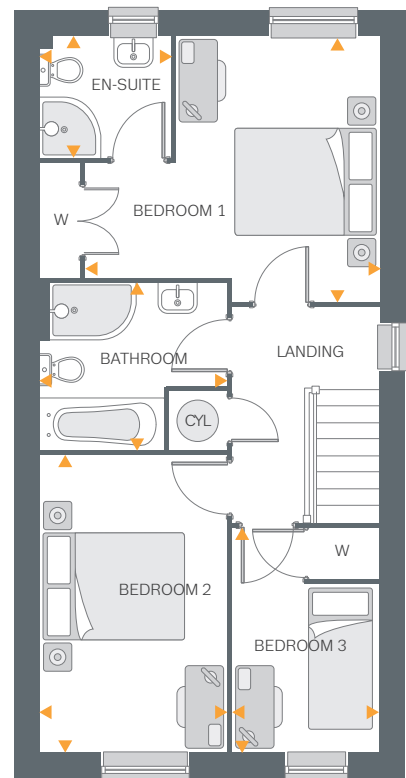

First Floor