

THE SOLWAY

THREE BEDROOM HOME



The Solway is an impressive home with plenty of living space spread across three perfectly laid out floors. On the ground floor you'll find a spacious lounge and a separate open plan dining kitchen with a glazed pod and French doors providing attractive views of the garden. In summer, you can throw the doors open and step outside for that family BBQ or a spot of al fresco dining.

To the first floor are two double bedrooms which offer plenty of choice whether you want to create a nursery, guest bedroom or home office. There is also a family bathroom with bath and separate shower cubicle.

The second floor is where you'll find the luxurious principal bedroom with walk-in wardrobe and en-suite.

Outside are turfed gardens, driveway and garage.

THE SOLWAY

THREE BEDROOM HOME



Lounge with bay window



Open plan dining kitchen with French doors to garden



Modern family bathroom with bath & separate shower



Private floor for principal bedroom with walk-in wardrobe & en-suite



High quality kitchen appliances



Hive smart heating system



Fully turfed rear garden



Driveway & garage

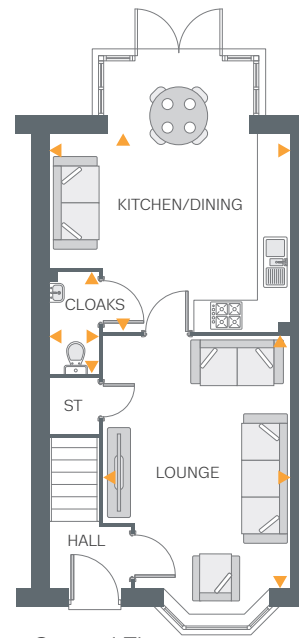

Ground Floor



First Floor

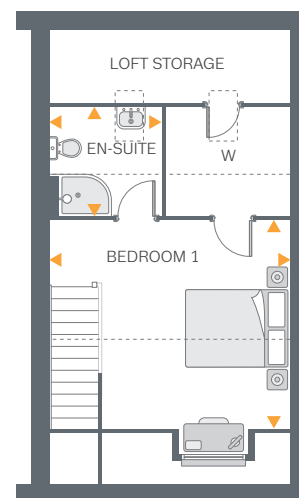

Second Floor

----- Area of reduced ceiling height.

Ground Floor

Lounge	14'9" x 11'7"	4.52m x 3.54m
Kitchen/Dining	15'2" x 12'6"	4.64m x 3.82m
Cloakroom	6'4" x 3'3"	1.95m x 1.01m

First Floor

Bedroom 2	13'1" x 10'0"	3.99m x 3.07m
Bedroom 3	12'2" x 8'3"	3.71m x 2.52m
Bathroom	8'4" x 8'3"	2.55m x 2.52m

Second Floor

Bedroom 1	15'1" x 13'3"	4.60m x 4.04m
En-suite	6'11" x 6'11"	2.11m x 2.11m