

The Rowington

3-bedroom home

The Rowington is an attractive 3-bedroom, 3-storey home that's full of charming features. On the ground floor you'll find a spacious lounge that leads into a light and bright open-plan kitchen and dining area, with French doors overlooking the rear garden. Up the stairs to the first floor is where you'll find a modern family bathroom and two of the bedrooms, one which benefits from an en-suite shower room.

On the second floor lies the main bedroom which also enjoys its own en-suite for a little extra space and luxury. Other considerate features like built-in wardrobes, a ground floor cloakroom and modern appliances make this an excellent choice for couples and small families alike.



Features

- Open plan kitchen and dining area with French doors leading to rear garden
- Spacious separate lounge
- Principle bedroom with en-suite
- Family bathroom and en-suite shower room
- Three bedrooms with built-in wardrobes
- High quality Smeg kitchen appliances
- Private garden

Room dimensions

Ground Floor

LOUNGE	3842(max) x 4854mm	12'7" x 15'11"
KITCHEN/DINER		
ARROW A	2914mm	9'6"
ARROW B	4930mm	16'2"
ARROW C	3818mm	12'6"
ARROW D	2243mm	7'4"
ARROW E	5748mm	18'10"
ARROW F	4300mm	14'1"
CLOAKS	1010mm x 1907mm	3'3" x 6'3"

First Floor

BATHROOM	1950mm x 3305mm	6'4" x 10'10"
BEDROOM 2	2887mm x 3158mm	9'5" x 10'4"
WARDROBE	1896mm x 550mm	6'2" x 1'9"
EN-SUITE	1896mm x 1506mm	6'2" x 4'11"
BEDROOM 3	2887mm x 3178mm	9'5" x 10'5"
WARDROBE	1896mm x 507mm	6'2" x 1'7"

Second Floor

BEDROOM 1	4929mm x 4630mm	16'2" x 15'2"
WARDROBE	2543mm x 1851mm	8'4" x 6'0"
EN-SUITE	2093mm x 1851mm	6'10" x 6'0"

Ground Floor

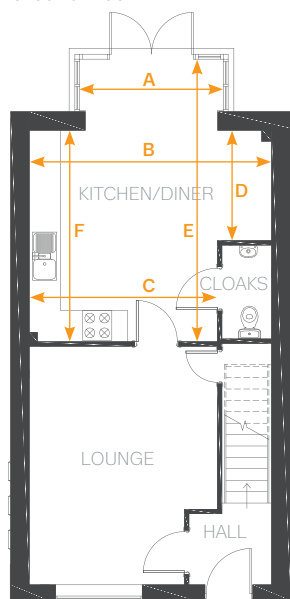

First Floor

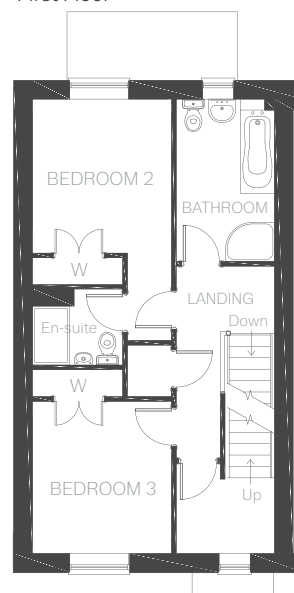

Second Floor

