

THE DOUGLAS

THREE BEDROOM HOME



As you walk through the front door and into the hallway of the Douglas, you'll soon discover the unique shape of this attractive home offers lots of living space, with an open plan dining kitchen with French doors to the garden, an inviting lounge, a useful storage cupboard and cloakroom.

To the first floor, the large principal bedroom has its own en-suite with shower and built-in wardrobe. Two further bedrooms share a modern family bathroom.

Outside there is a turfed garden, driveway, EV charger and garage.

THE DOUGLAS

THREE BEDROOM HOME



Inviting dual aspect lounge



Open plan dining kitchen



Downstairs cloakroom



Principal bedroom with built-in wardrobe & en-suite



High quality kitchen appliances



Hive smart heating system



Fully turfed rear garden



EV charger & garage

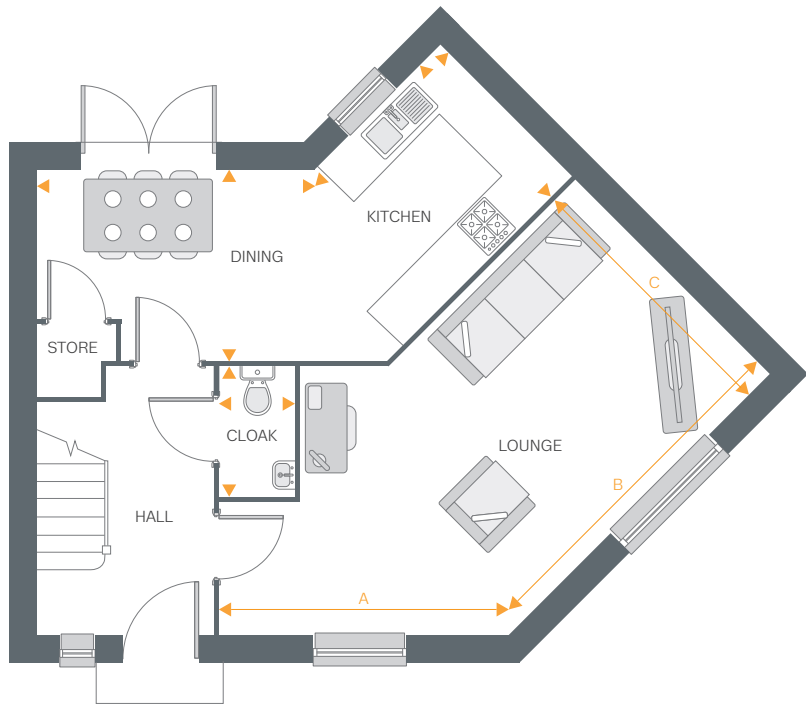

Ground Floor

Ground Floor

Lounge

Dim. A	12'1"	3.70m
Dim. B	15'6"	4.74m
Dim. C	11'5"	3.49m

Kitchen	7'8" x 7'5"	2.34m x 2.26m
---------	-------------	---------------

Dining	11'10" x 7'11"	3.61m x 2.42m
--------	----------------	---------------

Cloakroom	5'3" x 3'0"	1.62m x 0.92m
-----------	-------------	---------------

First Floor

Bedroom 1	12'2" x 9'5"	3.71m x 2.87m
Ensuite	6'10" x 6'0"	2.08m x 1.84m

Bedroom 2	11'6" x 9'2"	3.51m x 2.79
-----------	--------------	--------------

Bedroom 3

Dim. A	4'7"	1.39m
Dim. B	8'6"	2.60m
Dim. C	7'9"	2.38m

Bathroom	6'11" x 6'3"	2.12m x 1.92m
----------	--------------	---------------



First Floor

All drawings, plans, and images are for illustrative purposes only. Room measurements are approximate. Finishes and layouts may vary and, during the construction process, plans might be subject to change. For more information, speak to your Sales Consultant.