

# THE DOVE

## THREE BEDROOM HOME



Traditional on the outside and modern on the inside, the Dove is an attractive home designed for contemporary living. The open plan dining kitchen has French doors that open out onto the garden creating a light, airy living space inside, and easy outdoor dining in the warmer months. There's also an inviting lounge, cloakroom and useful understairs storage cupboard.

Upstairs, the spacious principal bedroom has its own en-suite and built-in wardrobe, while two further bedrooms share a modern family bathroom.

Outside there is a turfed garden, driveway, EV charger and garage to selected plots.

# THE DOVE

## THREE BEDROOM HOME



Inviting lounge



Open plan dining kitchen with French doors to garden



Downstairs cloakroom



Principal bedroom with built-in wardrobe & en-suite



High quality kitchen appliances



Hive smart heating system



Fully turfed rear garden



Garage to selected plots

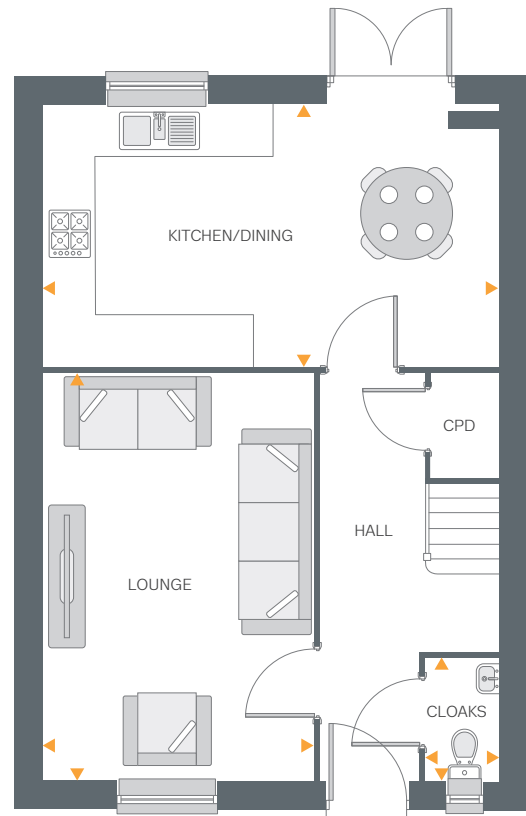

Ground Floor

### Ground Floor

Lounge	16'2" x 10'8"	4.93m x 3.27m
Kitchen/Dining	18'1" x 10'4"	5.53m x 3.15m
Cloakroom	4'9" x 2'10"	1.47m x 0.87m

### First Floor

Bedroom 1	12'9" x 9'4"	3.89m x 2.87m
En-suite	9'6" x 3'3"	2.92m x 1.00m
Bedroom 2	10'4" x 9'10"	3.15m x 3.02m
Bedroom 3	8'6" x 8'4"	2.60m x 2.56m
Bathroom	7'10" x 6'2"	2.41m x 1.90m

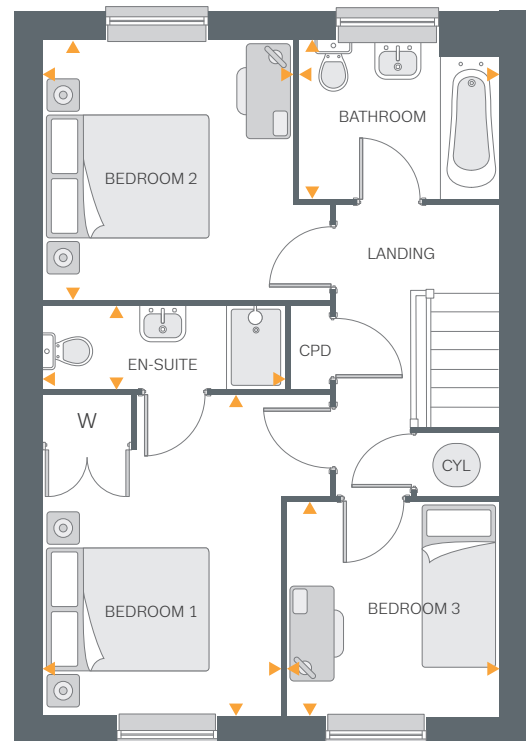

First Floor