

THE SOLENT

FOUR BEDROOM HOME



Computer generated images are for illustration purposes only.

The Solent is a spacious family home with a traditional look and practical layout. Step through the hallway and into a spacious open plan dining kitchen with views to the front and rear, you'll also find a generous lounge, a useful utility room and cloakroom.

To the first floor are four good sized bedrooms and a modern family bathroom. The principal bedroom includes built-in wardrobes and its own en-suite. Any of the bedrooms could easily be transformed into the peaceful home office you've always wanted.

Outside there are turfed gardens, driveway, EV charger and garage.

THE SOLENT

FOUR BEDROOM HOME



Inviting dual aspect lounge



Open plan dining kitchen



Downstairs cloakroom



Principal bedroom with built-in wardrobe & en-suite



High quality kitchen appliances



Hive smart heating system



Fully turfed rear garden



EV charger and garage

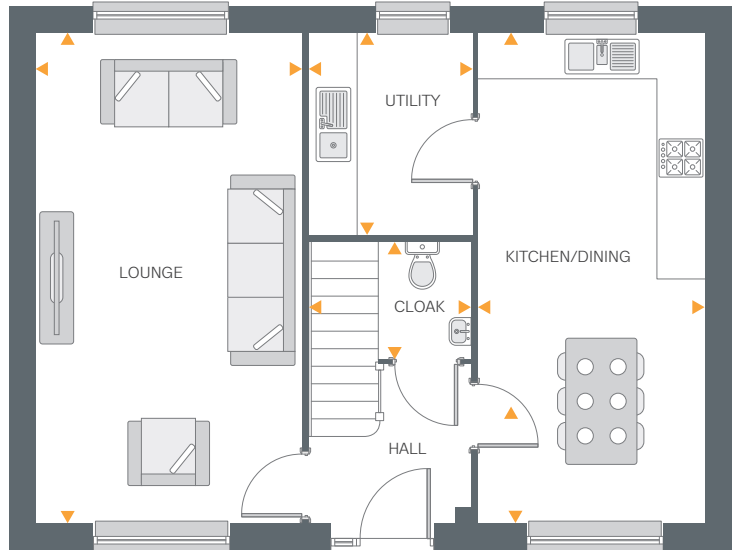

Ground Floor

Ground Floor

Lounge	21'1" x 11'4"	6.45m x 3.47m
Kitchen/Dining	21'1" x 9'7"	6.45m x 2.94m
Utility	8'7" x 7'0"	2.63m x 2.14m
Cloakroom	6'10" x 4'11"	2.08m x 1.51m

First Floor

Bedroom 1	12'8" x 11'6"	3.87m x 3.51m
Ensuite	7'0" x 6'10"	2.15m x 2.10m
Bedroom 2	10'7" x 9'9"	3.23m x 2.98m
Bedroom 3	9'9" x 8'0"	2.98m x 2.46m
Bedroom 4	8'3" x 8'0"	2.51m x 2.46m
Bathroom	10'2" x 4'9"	3.10m x 1.46m

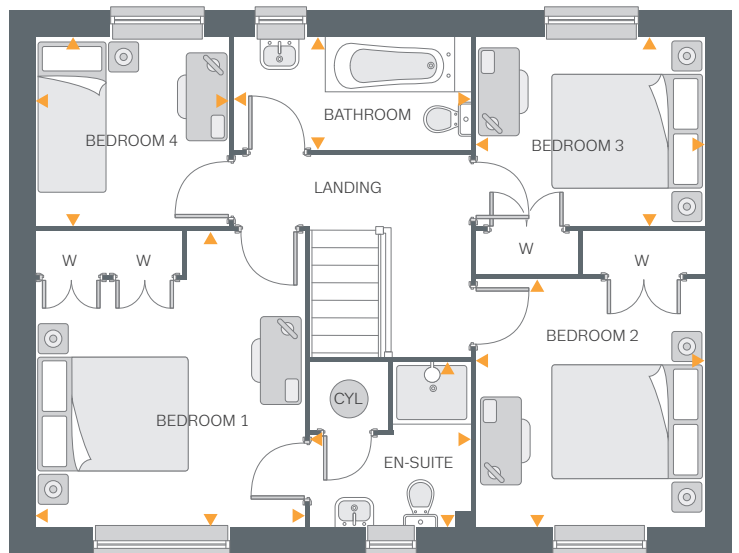

First Floor