



The Dove

3 bedroom home

Traditional on the outside, modern on the inside, the Dove is an attractive home with lots of great design features. The open plan kitchen and dining area has French doors that open out onto the garden, creating a light, airy living space inside, and easy outdoor dining in the warmer months. There's also a generous lounge and downstairs cloakroom.

Upstairs feels just as light and bright. The spacious principal bedroom has its own en-suite and built-in wardrobe, while two more bedrooms share a modern family bathroom. You could even turn one of them into the perfect, peaceful home office.



Features

- Open plan kitchen & dining area with French doors to garden
- Inviting lounge
- Downstairs cloakroom
- Principal bedroom with built-in wardrobe & en-suite
- High quality Smeg kitchen appliances
- Hive smart heating system
- Fully turfed rear garden
- Garage to selected plots

Room Dimensions

Ground Floor

Lounge	16'0" x 10'7"	4.89m x 3.24m
Kitchen/Dining	17'10" x 10'4"	5.45m x 3.15m
Cloakroom	4'10" x 2'10"	1.47m x 0.87m

First Floor

Bedroom 1	12'5" x 9'5"	3.80m x 2.87m
En-suite	9'3" x 3'4"	2.82m x 1.04m
Bedroom 2	10'4" x 9'7"	3.15m x 2.94m
Bedroom 3	8'6" x 8'1"	2.60m x 2.48m
Bathroom	7'11" x 6'1"	2.41m x 1.87m

Ground Floor

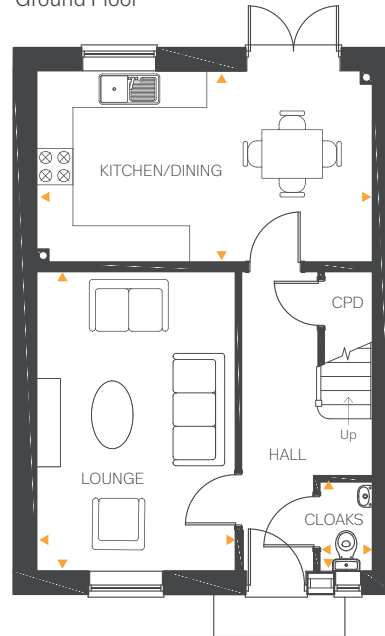

First Floor

