



The Lea

3 bedroom home

Thoughtfully laid out and full of great design details, the Lea is an attractive, practical three bedroom home. The spacious lounge has a beautiful bay window and leads through to an open plan dining kitchen with separate utility room and cloakroom. The French doors from the dining area take you straight out to the garden, creating a light, airy space you'll love all year round.

Up on the first floor, you'll find a principal bedroom with built-in wardrobe and en-suite, plus two further bedrooms and a modern family bathroom. Looking for space to work from home? Bedrooms two or three would make the perfect home office.



Features

- Open plan dining kitchen with French doors
- Lounge with feature bay window
- Useful utility room
- Principal bedroom with en-suite
- Built-in wardrobes to 2 bedrooms
- High quality Smeg kitchen appliances
- Hive smart heating system
- Fully turfed rear garden
- Garage

Room Dimensions

Ground Floor

Lounge	17'2" x 12'1"	5.23m x 3.69m
Kitchen/Dining	15'5" x 12'1"	4.70m x 3.69m
Utility	5'9" x 4'5"	1.77m x 1.35m
Cloakroom	5'6" x 2'11"	1.69m x 0.91m

First Floor

Bedroom 1	13'3" (max) x 12'1" 9'1" (min)	4.05m (max) x 3.69m 2.78m (min)
En-suite	5'11" x 5'5"	1.82m x 1.67m
Bedroom 2	13'7" x 8'6"	4.14m x 2.61m
Bedroom 3	10'2" x 6'6"	3.12m x 1.99m
Bathroom	8'6" x 7'6"	2.61m x 2.29m

Ground Floor

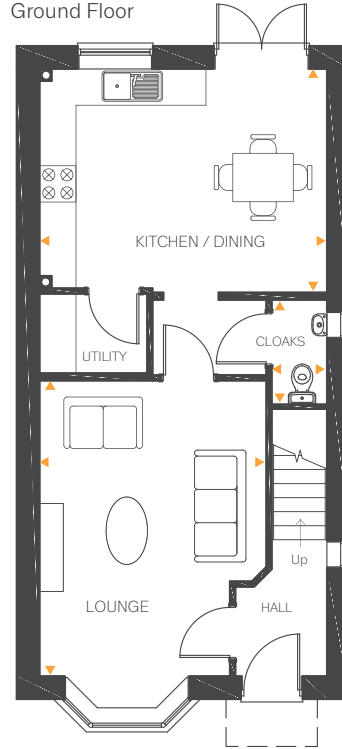

First Floor

