



# The Lydden

---

## 4 bedroom home

The Lydden is a beautiful home with a traditional look you'll love. Step through the porch into an inviting hallway, then into a light filled generous lounge. Double doors lead through to a stunning L shaped open plan kitchen, dining and living space. Just like the lounge, it has French doors taking you straight out onto the fully turfed garden, perfect for relaxing weekends and easy family get togethers. There's also a separate utility room, cloakroom and useful storage.

Up on the first floor, you'll find a principal bedroom with its own en-suite, built-in wardrobes and views over the garden. There are also three more bedrooms and a modern family bathroom which includes a bath and separate shower cubicle.



## Features

- Open plan kitchen & dining area opening out onto rear garden
- Lounge with French doors to garden
- Utility room
- Principal bedroom with en-suite
- Built-in wardrobes to bedrooms one & two
- High quality Smeg kitchen appliances
- Hive smart heating system
- Fully turfed rear garden
- Double garage

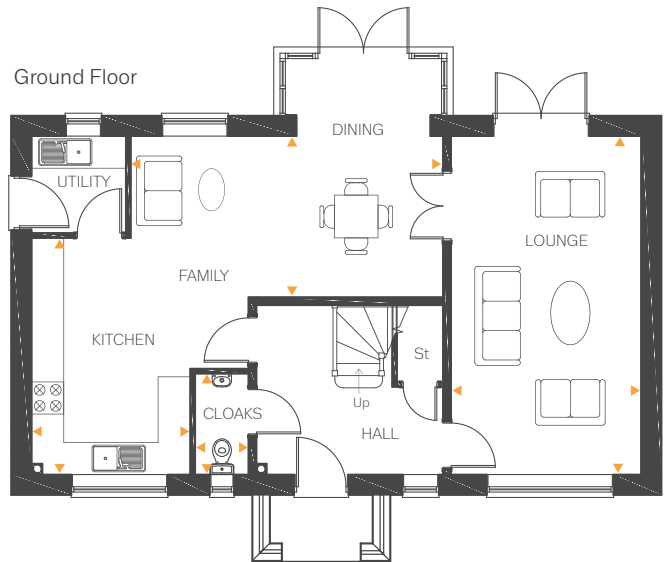

## Room Dimensions

### Ground Floor

Lounge	20'6" x 11'7"	6.25m x 3.55m
Kitchen	14'2" x 9'8"	4.33m x 2.96m
Family/Dining	18'11" x 9'11"	5.77m x 3.02m
Utility	5'11" x 5'10"	1.82m x 1.78m
Cloakroom	6'1" x 3'3"	1.87m x 0.99m

### First Floor

Bedroom 1	13'10" (max) x 13'4" (min)	4.21m (max) x 4.08m (min)
En-suite	6'9" x 5'6"	2.07m x 1.67m
Bedroom 2	10'10" x 10'1"	3.30m x 3.08m
Bedroom 3	11'10" x 10'1"	3.61m x 3.08m
Bedroom 4	8'6" (max) x 10'1" (min)	2.60m (max) x 3.07m (min)
Bathroom	8'5" x 6'9"	2.58m x 2.07m

