



The Teme

3 bedroom home

The Teme is designed for easy everyday living. Its welcoming hallway leads into an inviting lounge, while the open plan dining kitchen has French doors leading out to the garden, perfect for warm summer days. A cloakroom completes the ground floor.

To the first floor, you'll find a generous principal bedroom with built-in wardrobe, two further bedrooms and a modern family bathroom. So, whether you'd like a children's room, a guest room or the perfect home office, there's plenty of potential.



Features

- Inviting lounge
- Open plan dining kitchen with French doors to garden
- Cloakroom
- Principal bedroom with built-in wardrobe
- High quality Smeg kitchen appliances
- Hive smart heating system
- Fully turfed rear garden
- Garage to selected plots

Room Dimensions

Ground Floor

Kitchen/Dining	15'1" x 9'8"	4.60m x 2.95m
Lounge	15'1" x 10'11"	4.60m x 3.33m
Cloakroom	5'11" x 2'11"	1.80m x 0.91m

First Floor

Bedroom 1	15'1" x 9'8"	4.60m x 2.95m
Bedroom 2	9'8" x 6'10"	2.95m x 2.08m
Bedroom 3	7'11" x 7'8"	2.42m x 2.35m
Bathroom	7'4" x 6'1"	2.24m x 1.87m

Ground Floor

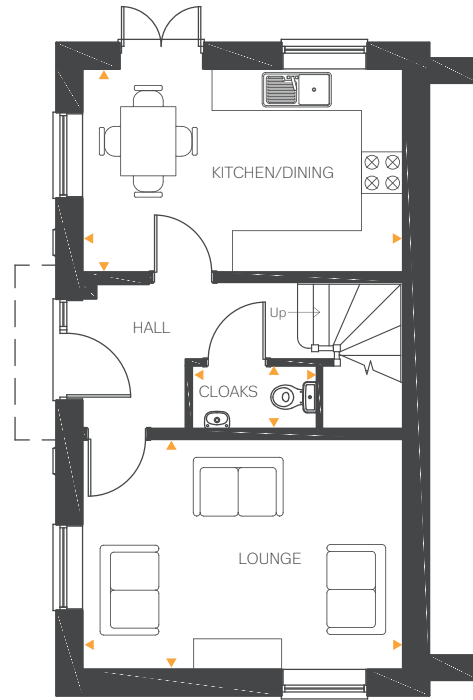

First Floor

